

Canllawiau Ymuno Google Classroom

-

Guide for joining Google Classroom

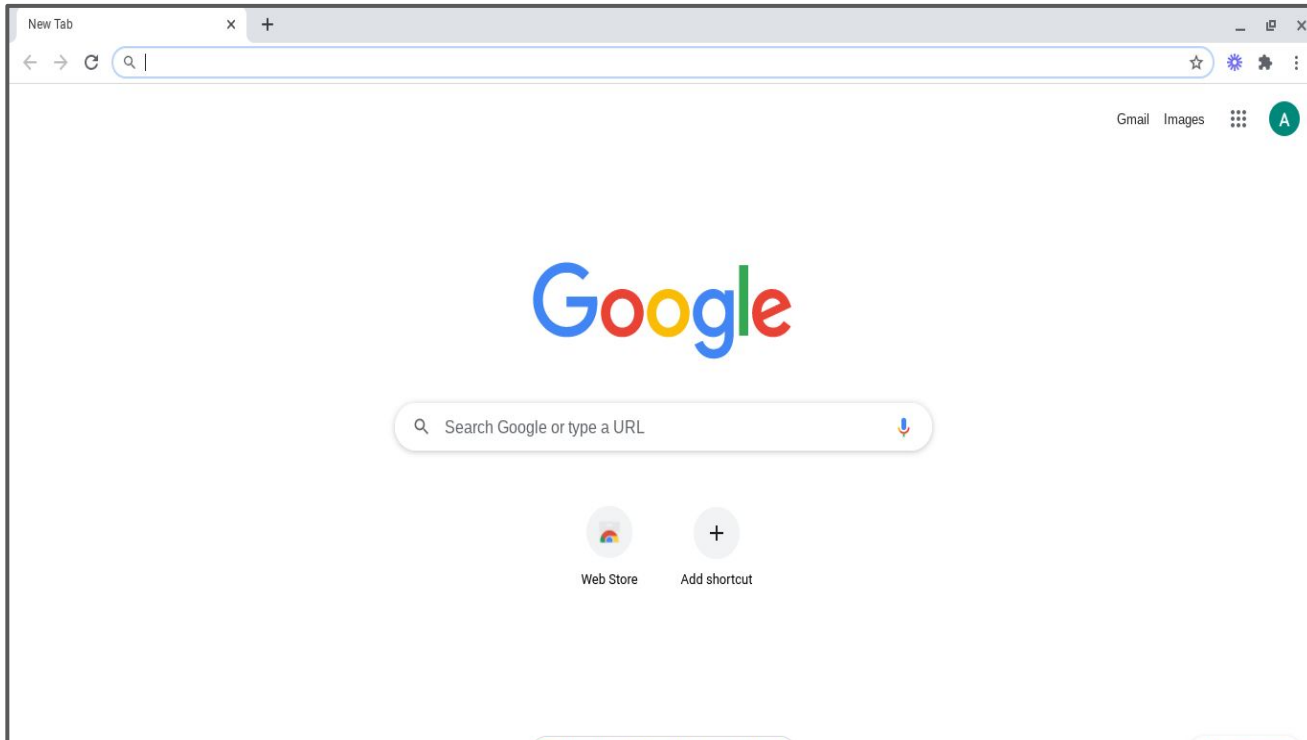



Dechreuwch gan fewngofnodi i Google ar eich cyfrifiadur neu declyn. Gwasgwch y botwm 'Sign in' glas a defnyddiwch eich manylion mewngofnodi ysgol sydd yn gorffen '@yggabercynon.cymru.' Bydd eich tudalen wedyn yn edrych fel hyn.

Begin by signing in to Google on your computer or device. Press the blue 'Sign in' button and use your school login details ending in '@yggabercynon.cymru.' Your page should then look like this.

Dewislen / Menu

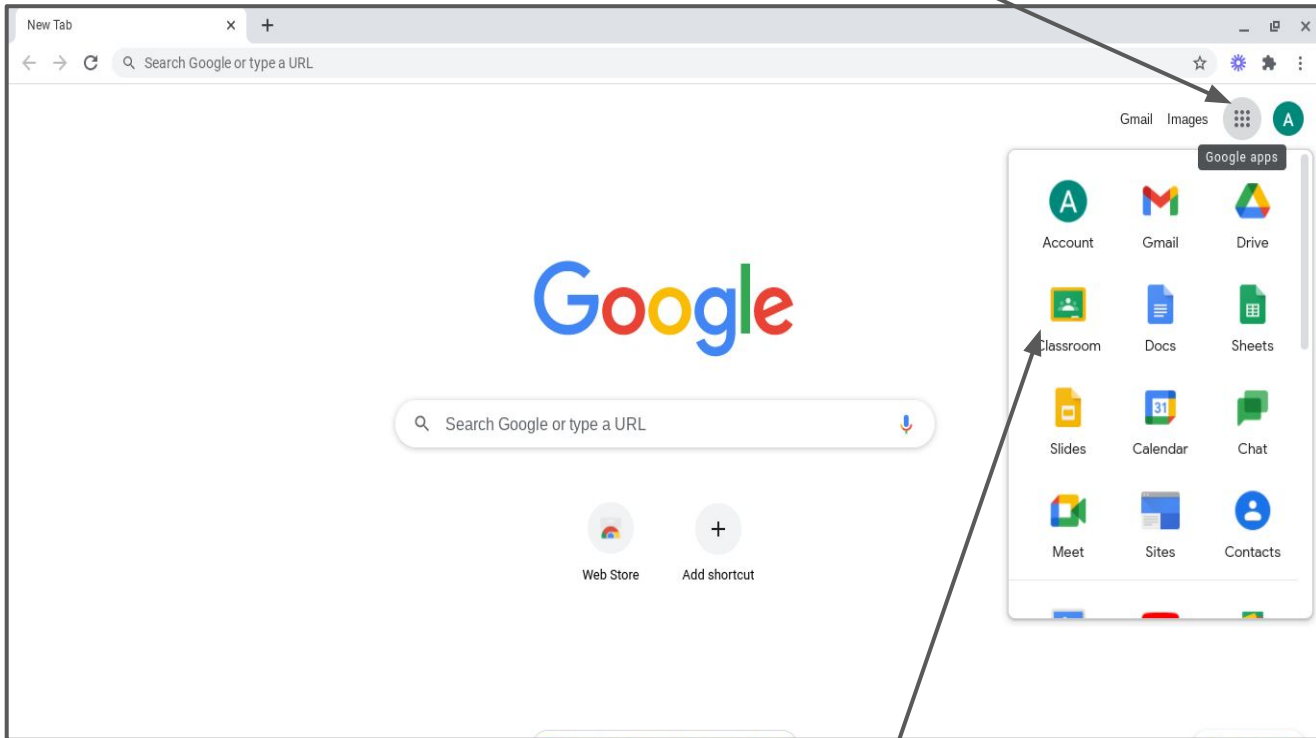

Classroom

Unwaith rydych wedi mewngofnodi, bydd dewislen / waffl yng nghornel dde'r dudalen, gwasgwch y ddewislen yma. Bydd nifer o apiau gwahanol yn ymddangos ar y ddewislen. Gwasgwch y symbol Classroom sydd yn wyrdd.

Once you have signed in, there will be a menu / waffle at the top right hand corner of the screen, press this menu. A list of apps will then appear below. Press the green Classroom symbol that appears on the list.

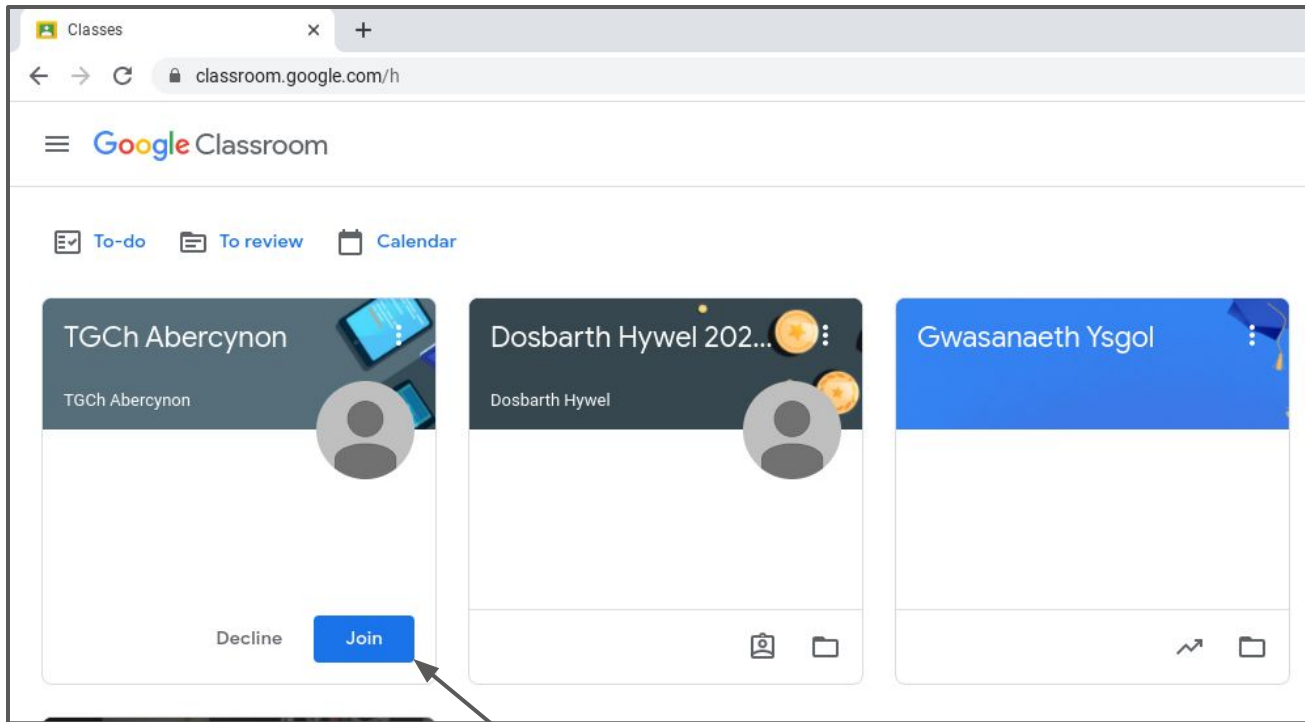

Botwm 'Join' / 'Join' button

Mae yna 2 ffordd i ymuno efo Classroom. Os ydych athro/athrawes dosbarth wedi anfon gwahoddiad i chi yn barod, bydd angen gwasgu'r botwm glas 'Join.' Unwaith rydych wedi gwasgu'r botwm yma fe fydddech yn cael mynediad sydd i Dudalen Classroom eich dosbarth chi.

There are 2 ways in which you can join Classroom. If your class teacher has sent you an invitation already, you will need to press the blue 'Join' button. Once you have pressed this button you will be able to access your Classroom page.

Botwm adio / Add button

The screenshot shows the Google Classroom homepage in a browser. At the top right, there is a grey circular button with a white plus sign. A dropdown menu is open below it, containing two options: 'Join class' and 'Create class'. Below the menu, there are four class cards. The first card is for 'TGCh Abercynon' and has a blue 'Join' button and a grey 'Decline' button. The other three cards are for 'Dosbarth Hywel 202...', 'Gwasanaeth Ysgol', and 'Tom's Training', each with a 'Join' button and a 'Decline' button. At the bottom of the page, there are navigation icons for 'To-do', 'To review', and 'Calendar'.

Join Class

Yr ail ffordd i ymuno efo Classroom os dydych chi ddim wedi derbyn gwahoddiad yw gwasgu'r symbol 'adio' ar dop y tudalen. Bydd rhestr fer yn ymddangos o dan, nawr bydd angen dewis 'Join Class.' Byddech wedyn yn cael eich arwain i dudalen arall.

The second way to join Classroom if you have not received an invitation is by pressing the 'add' button at the top right hand corner of the page. A drop down list will appear below and you'll need to select 'Join Class.' You will then be directed to a new page.

Join

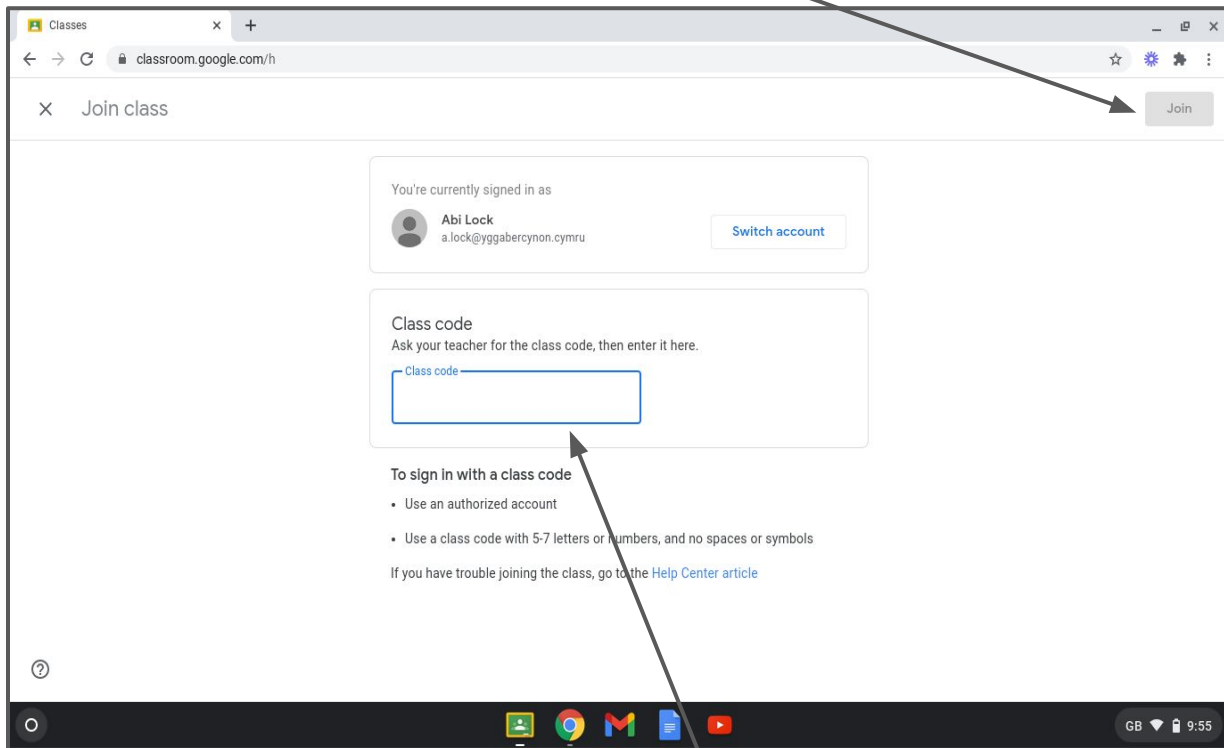

Cod dosbarth / Class code

Ar gyfer y cam yma, dylech wedi derbyn 'cod dosbarth' gan yr athro/athrawes. Bydd angen teipio'r cod i mewn i'r bocs cyn mynd ati i wasgu'r botwm glas 'Join' bydd yn ymddangos yn y cornel ar ôl i chi deipio'r cod i mewn. Dylech wedyn cyrraedd tudalen Classroom eich dosbarth.

For this step you should have received a 'Class code' from the class teacher. You will need to type the class code into the box before pressing the blue 'Join' button which will appear once you've typed the code in at the top right hand corner. You should then arrive at your Classroom page.

TGCh Abercynon



Upcoming

Woohoo, no work due soon!

[View all](#)



Share something with your class...



TGCh Abercynon

Nov 12



Bore da plant Abercynon!

Sut ydych chi gyd heddiw?



Add class comment...

